

## X-Fill Pro™

Paper Void Fill System

### HIGH PRODUCTIVITY AND RELIABLE VOID FILL SYSTEM

*Auto output and auto cut for ultra large user*

The user friendly design, incredible speed and voluminous paper pattern gives large to ultra void fill user a new horizon of productivity and experience.



### FEATURES & BENEFITS



**High productivity:** High speed output up to 2.1 m/s



**Versatile:** Four operation modes



**Easy to use:** LED display for data setting



**Customization:** Easy operation integration



**Efficiency:** Easy head angle adjustment, easy Jam Release Design and paper splicing



**Easy maintenance:** Modules design for easy and speedy set up, maintenance and services

## SPECIFICATIONS

<b>Speed:</b>	1.4m/s to 2.1m/s
<b>Certifications</b>	US : cTUVus, FCC EU: CE, EMC, RoHS
<b>Power Consumption</b>	38 W (Standby mode), 300 W (operation mode)
<b>Operation features:</b>	4 operation modes Foot pedal operation (one or two) Easy head angle adjustment

## PAPER OPTIONS

<b>Ply</b>	1	1	1
<b>Basic Weight</b>	50g	70g	80g
<b>Quality</b>	Recycled kraft paper	Recycled kraft paper	100 % Recycled paper
<b>Size(Wx L)</b>	760mm x 500m	760mm x 360m	700mm x 350m

## CONFIGURATIONS

<b>Model</b>	X-Fill Pro
<b>Type of stand</b>	Floor Stand
<b>Size(cm)</b>	L93x W83x H182-220
<b>Weight(kg)</b>	94



We use recycled and biodegradable paper to stay true to one of our main missions: environmental sustainability and protection of our planet.

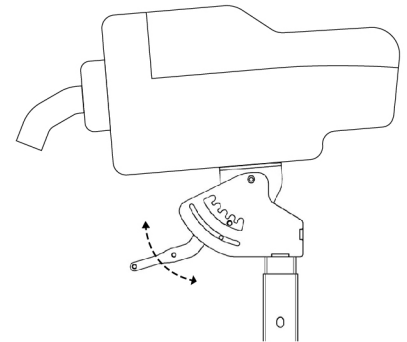

Easy head angle adjustment

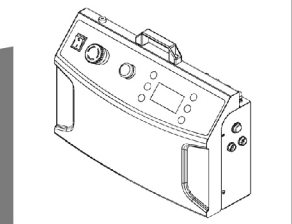

Simple and easy data setting

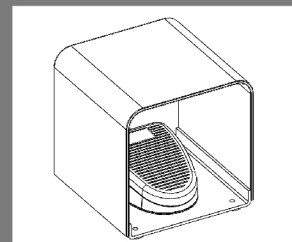

Can use two foot pedals for easy operation